

This product is intended for installation only by expert users. Please consult with a qualified technician for installation. Improper installation may result in damage to your equipment.

1. Please carefully read the manual before beginning the installation process !
2. It is strongly recommended to use market proven pre-mix coolant, such as Thermaltake Coolant 1000.
3. DO NOT USE any kind of alcohol or alcohol derivatives with this reservoir or the acrylic tube may crack and fail ! Do not clean it using alcohol either !

Parts List

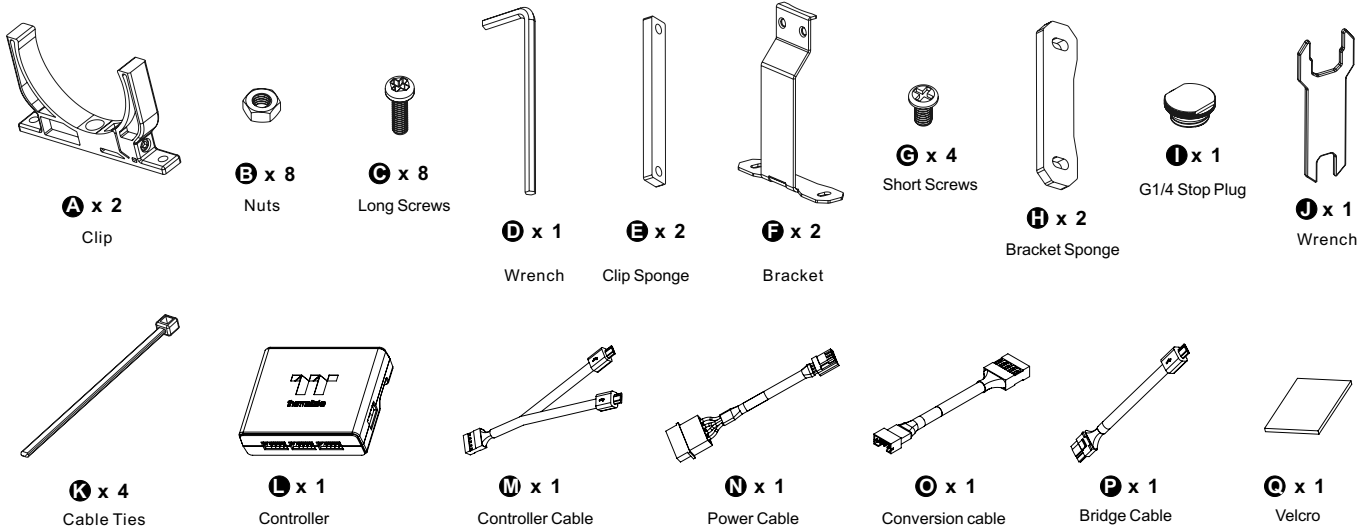

Installation Guide

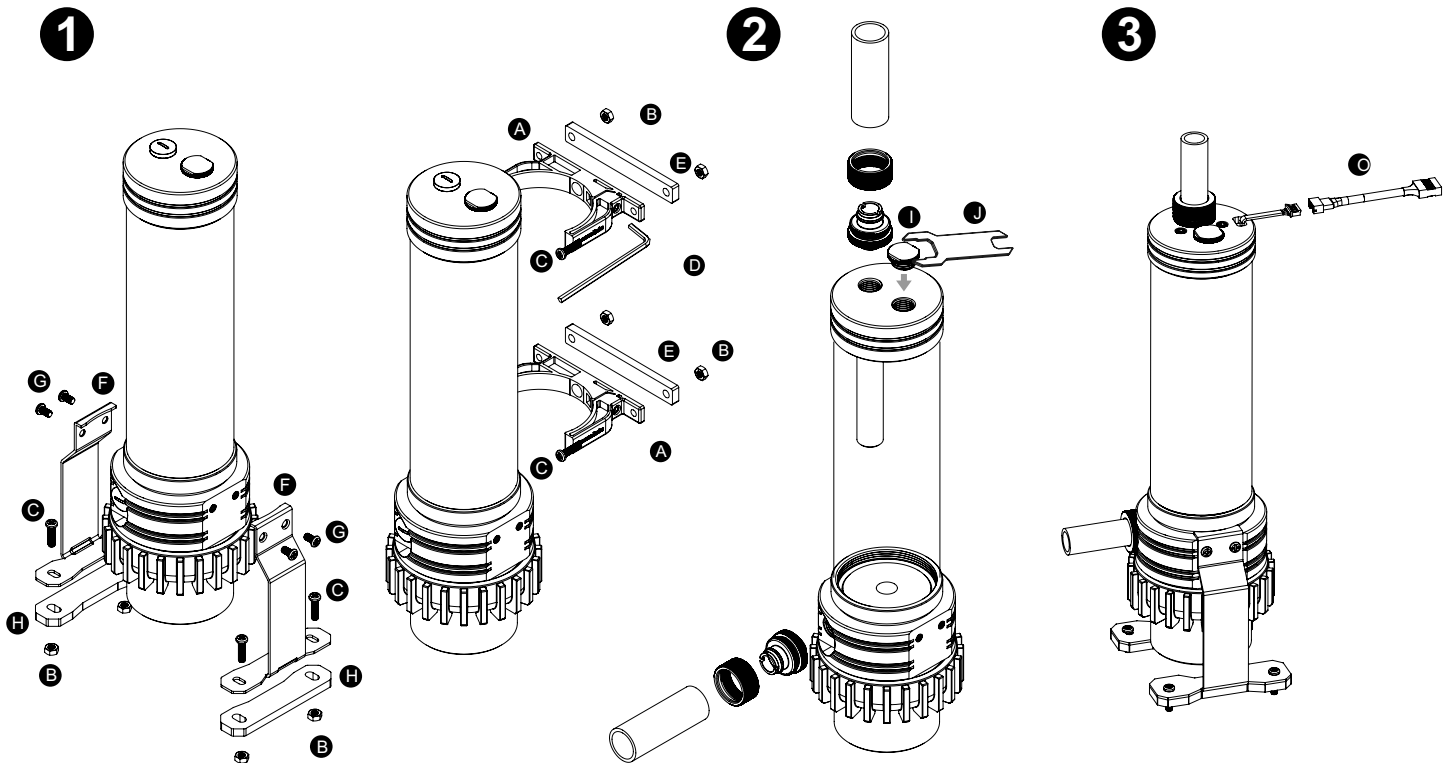

There are two types of mounting kits, please choose the mounting kit you want to use (Both types can be installed together)

Install your fittings and tubes, remember to use the bottom as an outlet and top as an inlet.

Connect the reservoir cable to the conversion cable.

Installation Guide

4

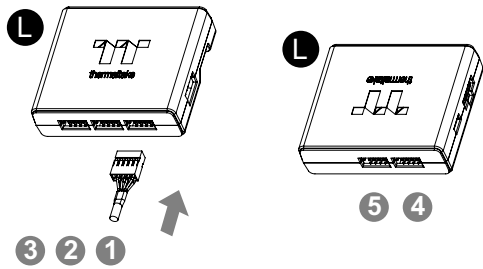

Connect the reservoir cable onto the controller.

5

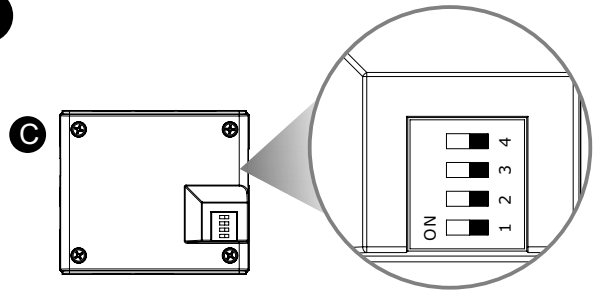

Set the DIP switch on the back side of the controller to assign the number of the controller

6

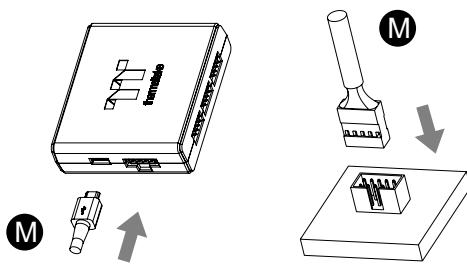

Connect the controller cable onto the mainboard (USB 2.0 9 pin) and controller.

NO.1

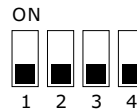

NO.2

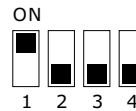

NO.3

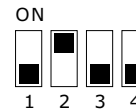

NO.4

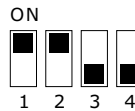

NO.5

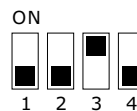

NO.6

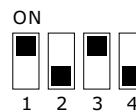

NO.7

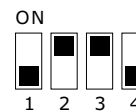

NO.8

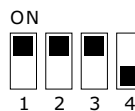

NO.9

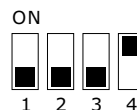

NO.10

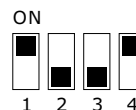

NO.11

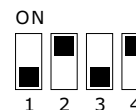

NO.12

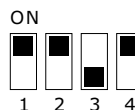

NO.13

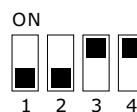

NO.14

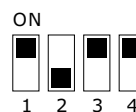

NO.15

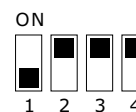

NO.16



7

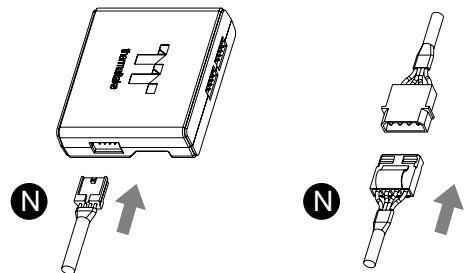

Connect the power cable to the 4pin Molex connector and controller.

8

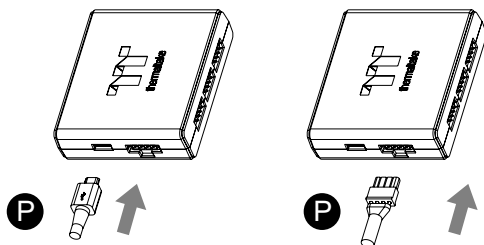

If you want to connect two or more connectors, you can use the bridge cable to connect the controllers.

9

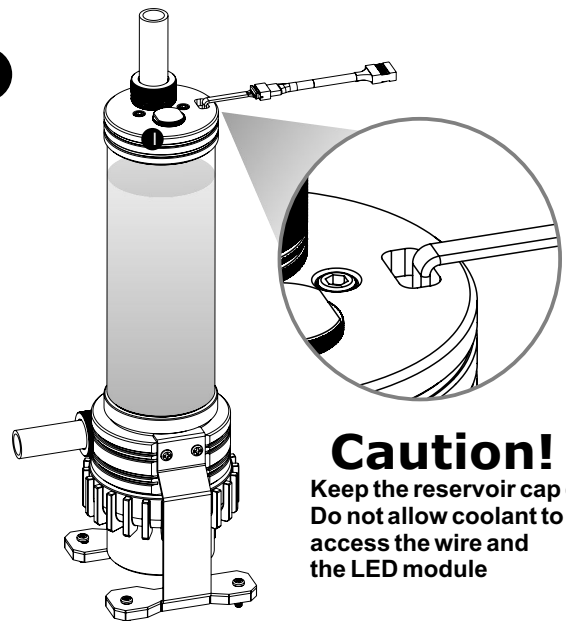

Caution!

Keep the reservoir cap dry!
Do not allow coolant to access the wire and the LED module

After adding the recommended coolant, remember to fill the reservoir to only 80% and leave the fill port cap off. This will help stabilize your internal loop pressure